

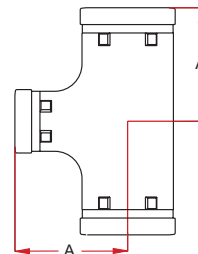

RACCORDS RAINURÉS / Té Style 65 / Té réduit style 55

Pression de service max: 34.5 bar.
Contactez Modgal pour les informations sur la pression de service pour la protection incendie.

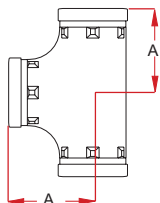

Diamètre nominal (pouce / DN)	Diamètre extérieur du tuyau	Dimensions	Poids Kg ⁵	Certifications
		A		
1" / 25	33.7	58.0	0.36	LPCB / VDS
1¼" / 32	42.4	70.0	0.66	FM / LPCB VDS
1½" / 40	48.3	70.0	0.75	FM / LPCB VDS
2" / 50	60.3	70.0	0.90	FM / UL LPCB / VDS
2½" / 65	76.1	76.0	1.35	FM / UL LPCB / VDS
3" / 80	88.9	85.5	1.80	FM / UL LPCB / VDS
4" OD	108.0	101.0	2.70	VDS
4" / 100	114.3	101.0	2.65	FM / UL LPCB / VDS
5" OD	133.0	-	-	-
5" / 125	139.7	124.0	5.0	FM / UL LPCB / VDS
6" OD	159.0	140.0	6.88	VDS
6" OD	165.1	140.0	8.23	FM / UL LPCB / VDS
6" / 150	168.3	140.0	7.26	FM / UL LPCB / VDS
8" / 200	219.1	174.0	13.63	FM / UL LPCB / VDS
10" / 250	273.0	-	-	-
12" / 300	323.9	-	-	-
14" / 350	355.6	-	-	-
16" / 400	406.4	-	-	-

Diamètre nominal (Pouce / DN) A	Diamètre extérieur du tuyau	Dimensions	Poids Kg.	Certifications
2½" x 2" / 65 x 50	76.1 x 60.3	76.0	1.20	UL
3" x 2" / 80 x 50	88.9 x 60.3	85.0	1.80	FM / UL
3 x 2½" / 80 x 65	88.9 x 76.1	85.0	1.90	UL
4" x 2" / 100 x 50	114.3 x 60.3	96.0	2.75	FM / UL
4" x 2½" / 100 x 65	114.3 x 76.1	101.0	3.00	FM / UL
4" x 3" / 100 x 80	114.3 x 88.9	101.0	3.00	FM / UL
5" x 2½" / 125 x 65	139.7 x 76.1	124.0	4.70	-
5" x 3" / 125 x 80	139.7 x 88.9	101.0	4.80	FM / UL
5" x 4" / 125 x 100	139.7 x 114.3	123.0	5.10	FM / UL
6" x 2" / 150 x 50	168.3 x 60.3	168.0	7.30	FM / UL
6" x 2½" / 150 x 65	168.3 x 76.1	139.0	7.20	-
6" x 3" / 150 x 80	168.3 x 88.9	139.0	6.50	FM / UL
6" x 4" / 150 x 100	168.3 x 114.3	139.0	7.00	FM / UL
8" x 3" / 200 x 80	219.1 x 88.9	175.0	13.00	FM / UL
8" x 4" / 200 x 100	219.1 x 114.3	175.0	12.80	FM / UL
8" x 5" / 200 x 125	219.1 x 139.7	175.0	12.50	FM
8" x 6" / 200 x 150	219.1 x 168.3	175.0	13.20	FM / UL
10" x 6" / 250 x 150	273.0 x 168.3	229.0	29.90	-
10" x 8" / 250 x 200	273.0 x 219.1	229.0	30.00	-
12" x 10" / 300 x 250	323.9 x 273.0	254.0	51.00	-

