

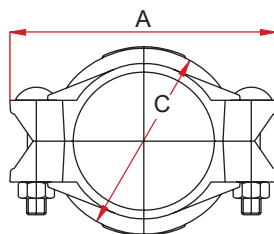

RACCORDS / Style 75 (FLEXIBLE)



1¼"-12"



14"-16"

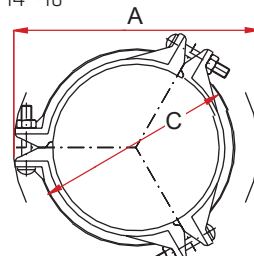

Raccord flexible léger

Pression de service max: 34.5 bar

Contactez Modgal pour les informations sur la pression de service pour la protection incendie.

Diamètre nominal (Pouce / DN)	Diamètre extérieur du tuyau	Dimensions des Raccords			Boulons			Charge Maximale en Newton †	Ecartés tolérés en bout de tube en mm	Déviation max. (à partir de l'axe)		Poids Kg	Certifications
		A	B	C	No.	Dimension x longueur				Degrés par Raccord	Cm pour 6 mtr. tuyau		
1¼" / 32	42.4	104.0	46.0	70.0	2	M10	x 51.0	4823	0 - 3.2	4°10'	44.2	0.68	FM / UL / LPCB / VDS
1½" / 40	48.3	114.0	46.0	78.0	2	M10	x 51.0	6318	0 - 3.2	3°56'	42.1	0.80	FM / UL / LPCB / VDS
2" / 50	60.3	125.0	46.0	91.0	2	M10	x 51.0	9847	0 - 3.2	3°25'	35.7	0.81	FM / UL / LPCB / VDS
2½" OD	73.0	142.0	46.0	101.5	2	M10	x 51.0	14432	0 - 3.2	2°49'	29.5	0.98	FM / UL / VDS
2½" / 65	76.1	144.0	46.0	106.0	2	M10	x 51.0	15725	0 - 3.2	2°23'	26.5	1.02	FM / UL / LPCB / VDS
3" / 80	88.9	161.5	46.0	118.5	2	M12	x 76.0	21404	0 - 3.2	1°05'	11.3	1.34	FM / UL / LPCB / VDS
4" OD	108.0	198.0	51.0	144.0	2	M12	x 76.0	31589	0 - 6.4	2°30'	26.7	1.97	FM / UL / VDS
4" / 100	114.3	198.0	50.0	150.0	2	M12	x 76.0	35382	0 - 6.4	3°23'	35.4	1.94	FM / UL / LPCB / VDS
5" OD	133.4	238.0	52.5	172.5	2	M16	x 89.0	48195	0 - 6.4	1°40'	17.4	3.18	FM / UL / VDS
5" / 125	139.7	245.5	52.0	179.5	2	M16	x 89.0	52854	0 - 6.4	2°45'	28.8	3.22	FM / LPCB / VDS
6" OD	159.0	271.0	53.5	200.0	2	M16	x 89.0	68295	0 - 6.4	2°09'	22.9	3.70	FM / VDS
6" OD	165.1	276.0	52.0	207.0	2	M16	x 89.0	73822	0 - 6.4	2°12'	23.5	3.65	FM / UL / LPCB / VDS
6" / 150	168.3	275.5	52.0	207.0	2	M16	x 89.0	76711	0 - 6.4	1°10'	12.5	3.20	FM / UL / LPCB / VDS
8" / 200	219.1	345.0	60.0	269.0	2	M20	x 120.0	130009	0 - 6.4	1°41'	17.6	7.14	FM / UL / LPCB / VDS
10" / 250	273.0	410.0	67.0	338.0	2	M22	x 181.0	201843	0 - 6.4	0°40'	7.2	10.41	VDS
12" / 300	323.9	469.0	66.0	376.0	2	M22	x 181.0	284126	0 - 6.4	0°40'	7.2	11.33	VDS
14" / 350	355.6	519.0	73.0	415.0	3	M22	x 140.0	342462	0 - 6.4	-	-	17.73	
16" / 400	406.4	580.0	73.0	470.0	3	M22	x 140.0	447297	0 - 6.4	-	-	20.52	

